

DOUBLE RATCHET WRENCH



EGA Master manufactures a comprehensive range of wrenches including: Mastergear, combination, open ended, etc.

The double ratchet wrench and the offset double ratchet wrench are designed for tightening screws or nuts in confined areas such as car engines.

Both in mm and inches

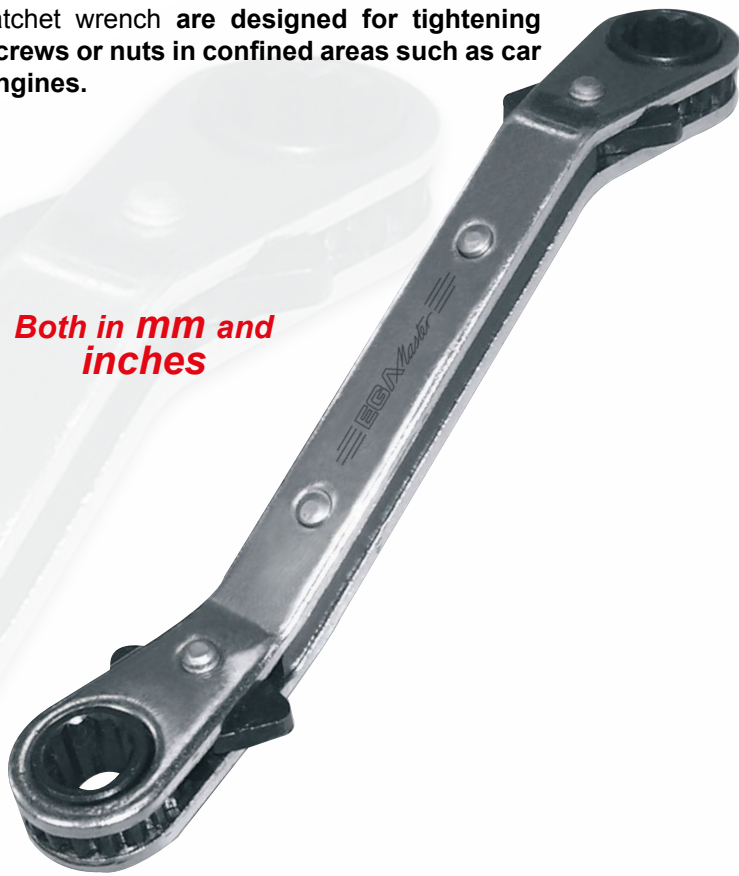

1. It allows us to tighten nuts even in hard to reach areas with greater comfort.

2. Fully reversible with a simple movement of the side tab.



3. 18 teeth.

4. Sizes from 8-10mm and 1/4"- 5/16" to 19-21mm and 3/4" 7/8".



DOUBLE RATCHET WRENCH MM

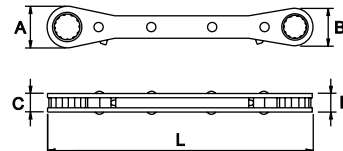

COD.	AF mm	L (mm)	A (mm)	B (mm)	C (mm)	D (mm)	g	Icon 1	Icon 2
65107	8-10	150	18	17	9,0	9,0	90		
65108	10-11	170	22	19	9,0	9,0	120	6	
65109	12-13	180	26	21	9,5	9,5	140		
65110	14-15	210	33	30	10	10	200		
65111	14-17	210	33	33	11	10	210	10	
65112	19-21	230	40	37	11	10	260		

DOUBLE RATCHET WRENCH INCH.

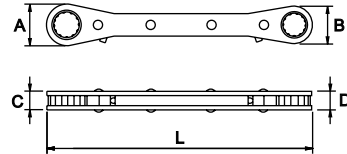

COD.	AF inch	L (mm)	A (mm)	B (mm)	C (mm)	D (mm)	g	Icon	Icon
65113	1/4-5/16	150	18	18	8,5	8,5	60		
65114	3/8-7/16	175	24	20	9,0	8,5	85	6	
65115	1/2-9/16	180	29	24	10	9,5	140		●
65116	5/8-11/16	210	36	33	11	10	200	10	
65117	3/4-7/8		40	37		12	260		

SETS

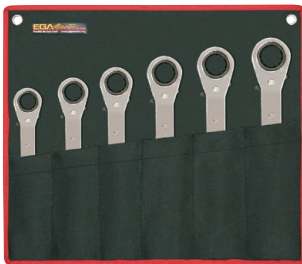

MM

COD.	PCS.	Icon	COD.	(mm)
68610	6	Icon	65107, 65108, 65109, 65110, 65111, 65112	8-10, 10-11, 12-13, 14-15, 14-17, 19-21

INCH.

COD.	PCS.	Icon	COD.	(inch)
68611	5	Icon	65113, 65114, 65115, 65116, 65117	1/4-5/16, 3/8-7/16, 1/2-9/16, 5/8-11/16, 3/4-7/8

OFFSET DOUBLE RATCHET WRENCH MM

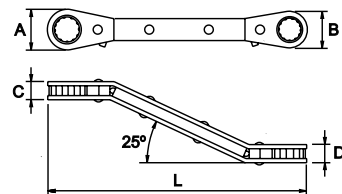

COD.	AF mm	L (mm)	A (mm)	B (mm)	C (mm)	D (mm)	g	Icon	Icon
65118	8-10	150	20	18	9,5	9,0	85		
65119	10-11	175	25	21	10	9,5	120	6	
65120	12-13	180	29	24	11	9,5	140		●
65121	14-15	210	36	33	11	10	200		
65122	14-17		40	37		10	210	8	
65123	19-21	230	41				260		

OFFSET DOUBLE RATCHET WRENCH INCH.

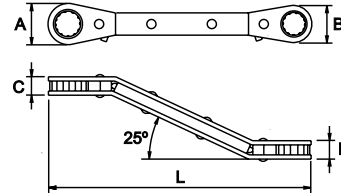

COD.	inch	L (mm)	A (mm)	B (mm)	C (mm)	D (mm)	g		
65124	1/4-5/16	150	20	17	9,5	8,5	60	6	●
65125	3/8-7/16	175	23	20		9,0	85		
65126	1/2-9/16	180	30	27	10	9,5	140	8	
65127	5/8-11/16	210	36	33		200			
65128	3/4-7/8		40	37		10	260		

SETS



MM

COD.	PCS.		COD.	(mm)
68612	6	90056	65118, 65119, 65120, 65121, 65122, 65123	8-10, 10-11, 12-13, 14-15, 14-17, 19-21

INCH.

COD.	PCS.		COD.	(inch)
68613	5	90056	65124, 65125, 65126, 65127, 65128	1/4-5/16, 3/8-7/16, 1/2-9/16, 5/8-11/16, 3/4-7/8

TECHNICAL SPECIFICATIONS

MATERIAL	Steel alloy
HARDNESS OF THE RING	>44 HRC
FINISHING	Chrome plating