

## WATER SUPPLY STUDDED REDUCTION FLANGE DUCTILE IRON PN10/16

Water supply studded reduction flange ductile iron PN10/16 for water supply, drinking water, watering and distribution networks.

With studs.

Carbon steel bolting Geomet 500 coated.

French water agreement ACS for drinking water.



**Size :** DN40 to DN300

**Connection :** PN10/16 RF

**Min Temperature :** +0°C

**Max Temperature :** +60°C

**Max Pressure :** 16 Bars

**Specifications :** With studs

Epoxy painting

Carbon steel bolting Geomet 500 coated

**Materials :** Ductile iron EN GJS-500-7

**WATER SUPPLY STUDDED REDUCTION FLANGE DUCTILE IRON PN10/16****SPECIFICATIONS :**

- Ductile iron body
- With studs
- Flange PN10/16
- Anti-corrosion Geomet 500 grade B coated bolting
- Epoxy painting blue color RAL 5017, 250 $\mu$  thickness

**USE:**

- Water supply and distribution networks
- Min and max Temperature Ts : + 0°C to + 60°C
- Max Pressure Ps : 16 bars

**RANGE :**

- Water supply studded adaptor flange PN10/16 **Ref.2510** from DN 40 to DN 300

**ACCESSORIES :**

- Undrilled black EPDM gasket ACS PN10/16 **Ref.9803178-9803187** from DN40 to DN300



- Drilled black EPDM gasket ACS PN10/16 **Ref.9803278-9803291** from DN40 to DN300



- Bolting kit, carbon steel Geomet 500 Grade B coated, 8.8 Class PN10/16 **Ref.2128** from DN40 to DN175



- Bolting kit, carbon steel Geomet 500 Grade B coated, 8.8 Class PN10 **Ref.2128** from DN200 to DN300



- Bolting kit, carbon steel Geomet 500 Grade B coated, 8.8 Class PN16 **Ref.2129** from DN200 to DN300

**WATER SUPPLY STUDDED REDUCTION FLANGE DUCTILE IRON PN10/16**

**MATERIALS :**

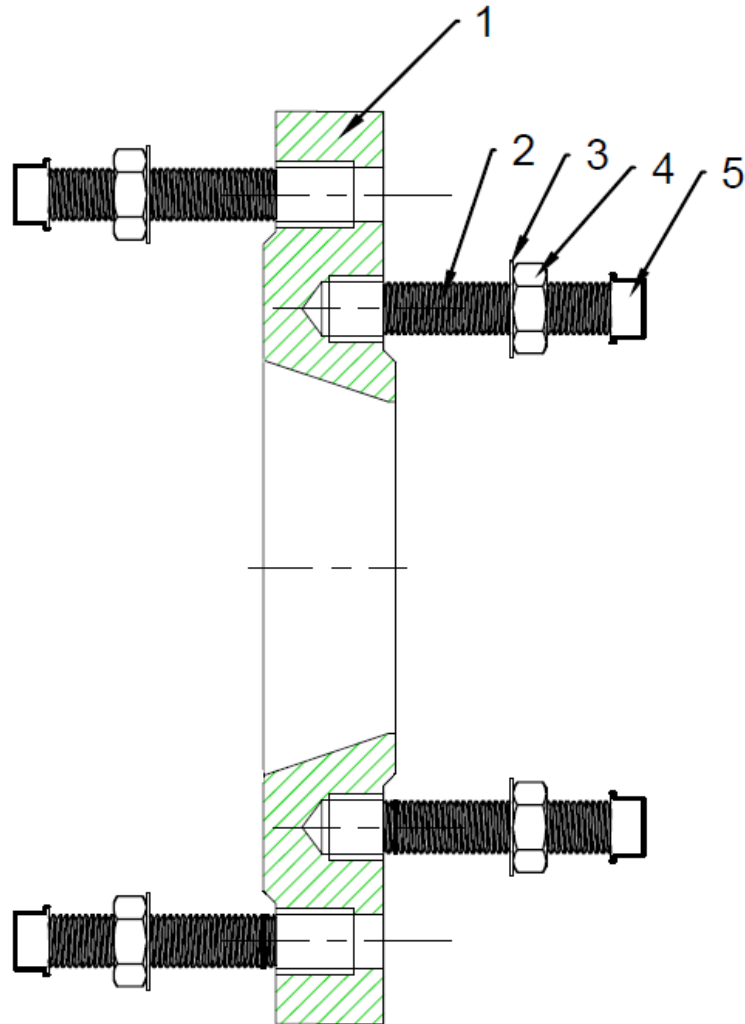

Item	Designation	Materials
1	Body	Ductile iron EN GJS-500-7
2	Stud	Carbon steel Geomet 500 Grade B coated Class 8.8
3	Washer	
4	Nut	
5	Cap	Plastic

## WATER SUPPLY STUDDED REDUCTION FLANGE DUCTILE IRON PN10/16

**SIZE DN60-200 ( in mm ) :**

**SINGLE STUDDED (TYPE SSA)**

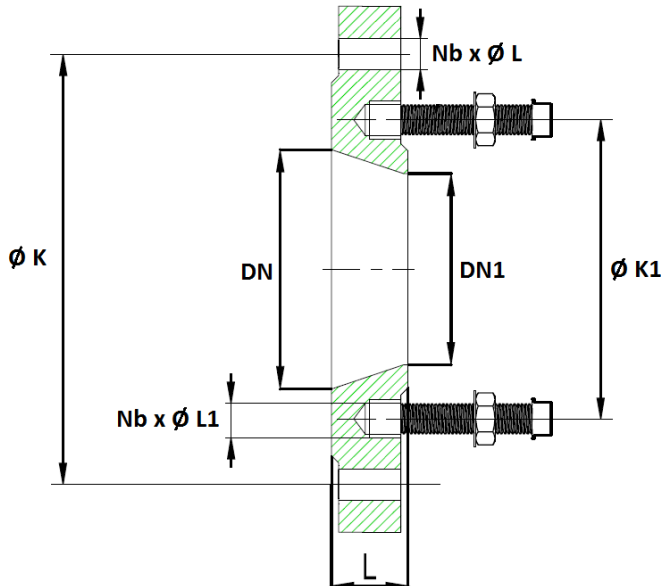

**DOUBLE STUDDED (TYPE DSA)**

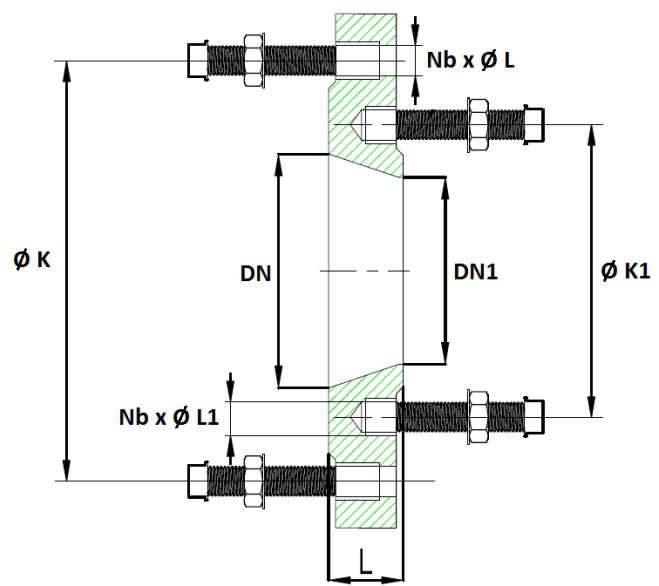

(60°) :bore diameter

DN	60	60	65	80	80	80	80	100	100	100	100	125
DN1	40	50	40	40	50	60	65 (60°)	40	60	65 (60°)	80	60
TYPE	DSA											
Ø K	135		145	160	160	160	160	180	180	180	180	210
Nb x Ø L	4 x M16		4 x M16	8 x M16	8 x M16	8 x M16	8 x M16	8 x M16	8 x M16	8 x M16	8 x M16	8 x M16
Ø K1	110	125	110	110	125	135	145	110	135	145	160	135
Nb x Ø L1	4 x M16		4 x M16	4 x M16	4 x M16	4 x M16	4 x M16	4 x M16	4 x M16	4 x M16	8 x M16	4 x M16
L	55	32	55	32	32	32	32	32	32	32	55	32
Weig. (Kg)	6	3.3	6.3	5.5	6	5.9	6.1	6.17	6.37	6.37	10.2	7.6
Ref.	2510060	2510061	2510065	2510080	2510081	2510082	2510083	2510100	2510102	2510103	2510104	2510125

DN	125	125	125	150	150	150	150	150	200 PN10	200 PN10
DN1	65 (60°)	80	100	60	65 (60°)	80	100	125	60	65 (60°)
TYPE	DSA	DSA	DSA	SSA	SSA	SSA	DSA	DSA	SSA	SSA
Ø K	210	210	210	240	240	240	240	240	295	295
Nb x Ø L	8 x M16	8 x M16	8 x M16	8 x 22	8 x 22	8 x 22	8 x M20	8 x M20	8 x 22	8 x 22
Ø K1	145	160	180	135	145	160	180	210	135	145
Nb x Ø L1	4 x M16	8 x M16	8 x M16	4 x M16	4 x M16	8 x M16	8 x M16	8 x M16	4 x M16	4 x M16
L	32	32	55	37	37	32	32	55	55	55
Weig. (Kg)	8	8.5	12.5	9.5	10.2	8.5	10.2	15.3	15	14.4
Ref.	2510126	2510127	2510128	2510150	2510151	2510152	2510153	2510154	2510200	2510201

## WATER SUPPLY STUDDED REDUCTION FLANGE DUCTILE IRON PN10/16

**SIZE DN200-300 ( in mm ) :**

**SINGLE STUDDED (TYPE SSA)**

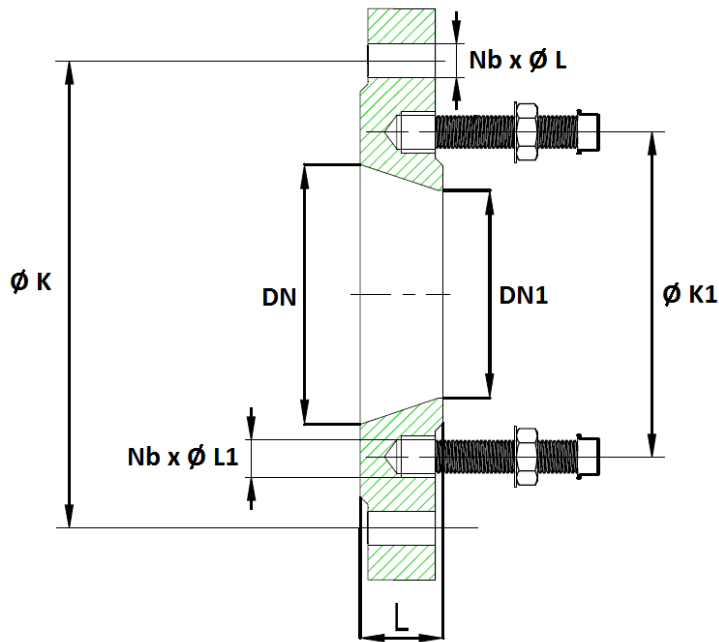

**DOUBLE STUDDED (TYPE DSA)**

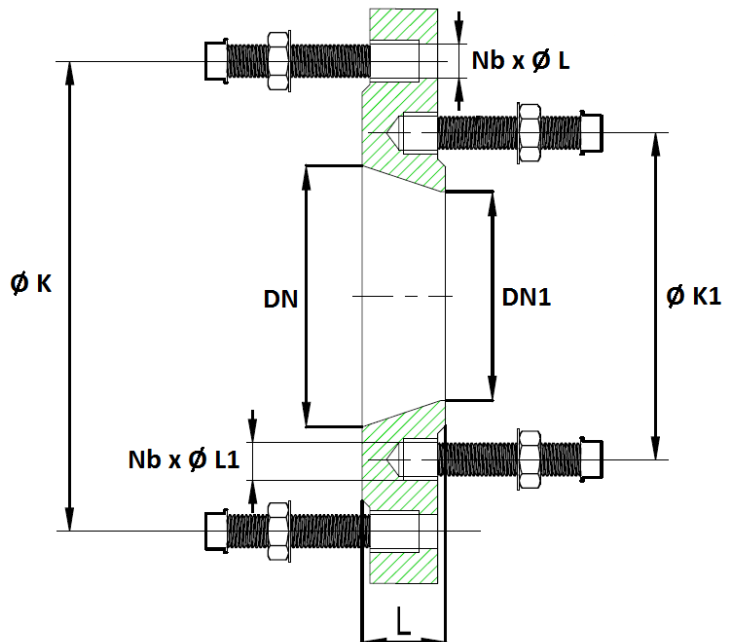

DN	200 PN10	200 PN10	200 PN10	200 PN10	200 PN16	250 PN10	250 PN10	300 PN10	300 PN10
DN1	80	100	125	150	150	150	200	200	250
TYPE	SSA	SSA	SSA	DSA	DSA	SSA	DSA	SSA	DSA
Ø K	295	295	295	295	295	350	350	400	400
Nb x Ø L	8 x 22	8 x 22	8 x 22	8 x M20	12 x M20	12 x 22	12 x M20	12 x 22	12 x M20
Ø K1	160	180	210	240	240	240	295	295	350
Nb x Ø L1	8 x M16	8 x M16	8 x M16	8 x M20	8 x M20	8 x M20	8 x M20	8 x M20	12 x M20
L	50	50	38	32	32	35	35	35	35
Weig. (Kg)	14.8	13.8	14.56	15	15.7	16.5	18.9	20.2	23.6
Ref.	2510202	2510203	2510204	2510205	2510206	2510250	2510251	2510300	2510301

**WATER SUPPLY STUDDERED REDUCTION FLANGE DUCTILE IRON PN10/16****STANDARDS :**

- Manufacturer certified ISO 9001 : 2015
- Directive 2014/68/EU : Products excluded from directive ( Article 1, § 2.b )
- Coated according to RoHS 2002/95/EC directive
- Flanges according to EN 1092-2 PN10-16
- Bolting with anti-corrosion coating according to NF EN ISO 9227 + NFA05-109
- Epoxy painting with French agreement **ACS N° 23 MAT LY 280**

**ADVICE :** Our opinion and our advice are not guaranteed and SFERACO shall not be liable for the consequences of damages.  
The customer must check the right choice of the products with the real service conditions.

## WATER SUPPLY STUDDED REDUCTION FLANGE DUCTILE IRON PN10/16

Water supply studded reduction flange ductile iron PN10/16 for water supply, drinking water, watering and distribution networks.

With studs.

Carbon steel bolting Geomet 500 coated.

French water agreement ACS for drinking water.



**Size :** DN40 to DN300

**Connection :** PN10/16 RF

**Min Temperature :** +0°C

**Max Temperature :** +60°C

**Max Pressure :** 16 Bars

**Specifications :** With studs

Epoxy painting

Carbon steel bolting Geomet 500 coated

**Materials :** Ductile iron EN GJS-500-7

**WATER SUPPLY STUDDED REDUCTION FLANGE DUCTILE IRON PN10/16****SPECIFICATIONS :**

- Ductile iron body
- With studs
- Flange PN10/16
- Anti-corrosion Geomet 500 grade B coated bolting
- Epoxy painting blue color RAL 5017, 250 $\mu$  thickness

**USE:**

- Water supply and distribution networks
- Min and max Temperature Ts : + 0°C to + 60°C
- Max Pressure Ps : 16 bars

**RANGE :**

- Water supply studded adaptor flange PN10/16 **Ref.2510** from DN 40 to DN 300

**ACCESSORIES :**

- Undrilled black EPDM gasket ACS PN10/16 **Ref.9803178-9803187** from DN40 to DN300



- Drilled black EPDM gasket ACS PN10/16 **Ref.9803278-9803291** from DN40 to DN300



- Bolting kit, carbon steel Geomet 500 Grade B coated, 8.8 Class PN10/16 **Ref.2128** from DN40 to DN175



- Bolting kit, carbon steel Geomet 500 Grade B coated, 8.8 Class PN10 **Ref.2128** from DN200 to DN300



- Bolting kit, carbon steel Geomet 500 Grade B coated, 8.8 Class PN16 **Ref.2129** from DN200 to DN300



**WATER SUPPLY STUDDED REDUCTION FLANGE DUCTILE IRON PN10/16**

**MATERIALS :**

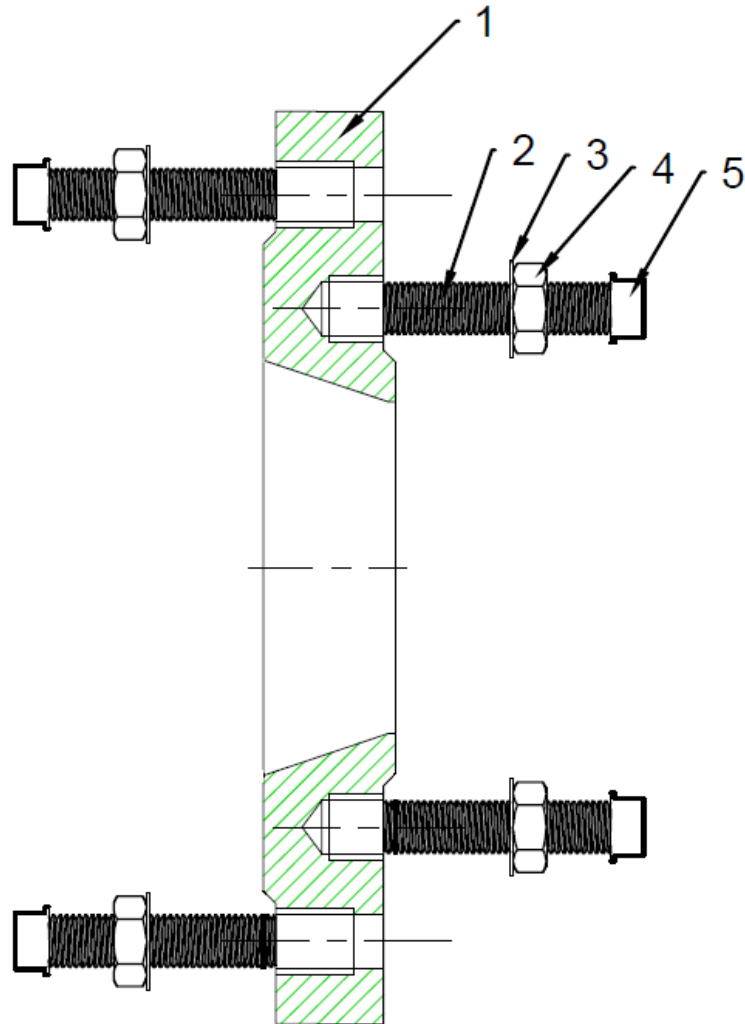

Item	Designation	Materials
1	Body	Ductile iron EN GJS-500-7
2	Stud	Carbon steel Geomet 500 Grade B coated Class 8.8
3	Washer	
4	Nut	
5	Cap	Plastic

## WATER SUPPLY STUDDED REDUCTION FLANGE DUCTILE IRON PN10/16

**SIZE DN60-200 ( in mm ) :**

**SINGLE STUDDED (TYPE SSA)**

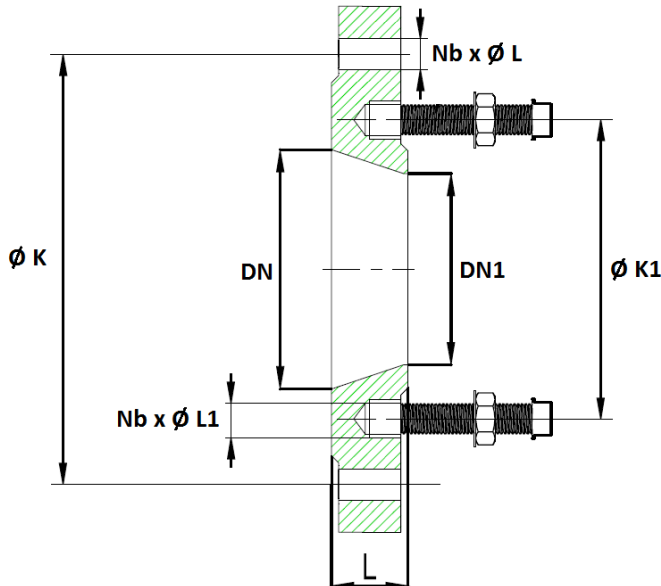

**DOUBLE STUDDED (TYPE DSA)**

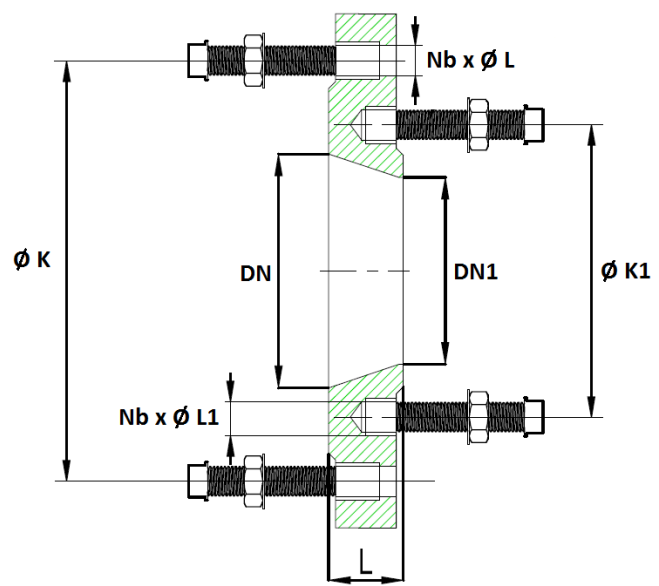

(60°) :bore diameter

DN	60	60	65	80	80	80	80	100	100	100	100	125
DN1	40	50	40	40	50	60	65 (60°)	40	60	65 (60°)	80	60
TYPE	DSA											
Ø K	135		145	160	160	160	160	180	180	180	180	210
Nb x Ø L	4 x M16		4 x M16	8 x M16	8 x M16	8 x M16	8 x M16	8 x M16	8 x M16	8 x M16	8 x M16	8 x M16
Ø K1	110	125	110	110	125	135	145	110	135	145	160	135
Nb x Ø L1	4 x M16		4 x M16	4 x M16	4 x M16	4 x M16	4 x M16	4 x M16	4 x M16	4 x M16	8 x M16	4 x M16
L	55	32	55	32	32	32	32	32	32	32	55	32
Weig. (Kg)	6	3.3	6.3	5.5	6	5.9	6.1	6.17	6.37	6.37	10.2	7.6
Ref.	2510060	2510061	2510065	2510080	2510081	2510082	2510083	2510100	2510102	2510103	2510104	2510125

DN	125	125	125	150	150	150	150	150	200 PN10	200 PN10
DN1	65 (60°)	80	100	60	65 (60°)	80	100	125	60	65 (60°)
TYPE	DSA	DSA	DSA	SSA	SSA	SSA	DSA	DSA	SSA	SSA
Ø K	210	210	210	240	240	240	240	240	295	295
Nb x Ø L	8 x M16	8 x M16	8 x M16	8 x 22	8 x 22	8 x 22	8 x M20	8 x M20	8 x 22	8 x 22
Ø K1	145	160	180	135	145	160	180	210	135	145
Nb x Ø L1	4 x M16	8 x M16	8 x M16	4 x M16	4 x M16	8 x M16	8 x M16	8 x M16	4 x M16	4 x M16
L	32	32	55	37	37	32	32	55	55	55
Weig. (Kg)	8	8.5	12.5	9.5	10.2	8.5	10.2	15.3	15	14.4
Ref.	2510126	2510127	2510128	2510150	2510151	2510152	2510153	2510154	2510200	2510201

## WATER SUPPLY STUDDED REDUCTION FLANGE DUCTILE IRON PN10/16

**SIZE DN200-300 ( in mm ) :**

**SINGLE STUDDED (TYPE SSA)**

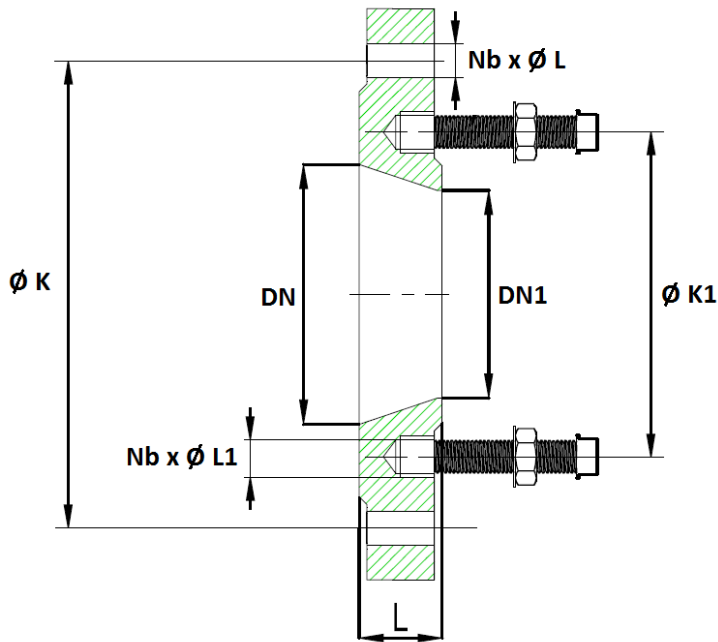

**DOUBLE STUDDED (TYPE DSA)**

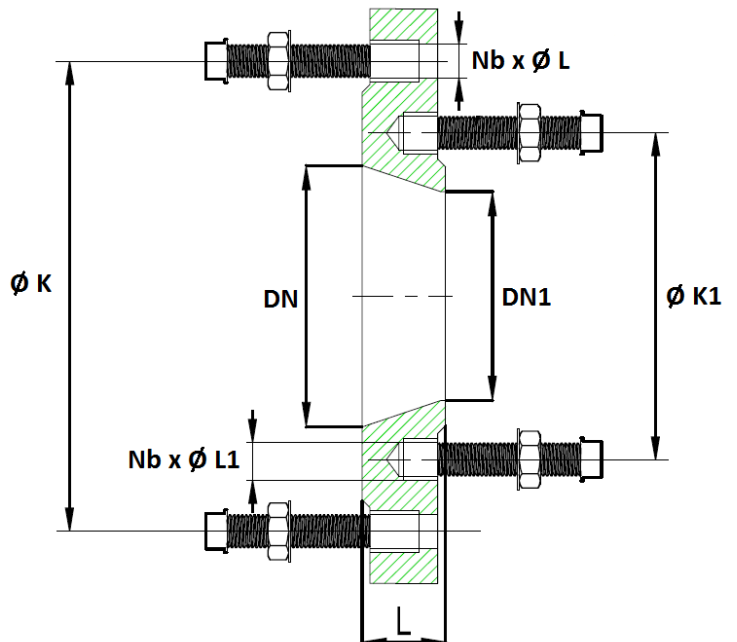

DN	200 PN10	200 PN10	200 PN10	200 PN10	200 PN16	250 PN10	250 PN10	300 PN10	300 PN10
DN1	80	100	125	150	150	150	200	200	250
TYPE	SSA	SSA	SSA	DSA	DSA	SSA	DSA	SSA	DSA
Ø K	295	295	295	295	295	350	350	400	400
Nb x Ø L	8 x 22	8 x 22	8 x 22	8 x M20	12 x M20	12 x 22	12 x M20	12 x 22	12 x M20
Ø K1	160	180	210	240	240	240	295	295	350
Nb x Ø L1	8 x M16	8 x M16	8 x M16	8 x M20	8 x M20	8 x M20	8 x M20	8 x M20	12 x M20
L	50	50	38	32	32	35	35	35	35
Weig. (Kg)	14.8	13.8	14.56	15	15.7	16.5	18.9	20.2	23.6
Ref.	2510202	2510203	2510204	2510205	2510206	2510250	2510251	2510300	2510301

**WATER SUPPLY STUDDED REDUCTION FLANGE DUCTILE IRON PN10/16****STANDARDS :**

- Manufacturer certified ISO 9001 : 2015
- Directive 2014/68/EU : Products excluded from directive ( Article 1, § 2.b )
- Coated according to RoHS 2002/95/EC directive
- Flanges according to EN 1092-2 PN10-16
- Bolting with anti-corrosion coating according to NF EN ISO 9227 + NFA05-109
- Epoxy painting with French agreement **ACS N° 23 MAT LY 280**

**ADVICE :** Our opinion and our advice are not guaranteed and SFERACO shall not be liable for the consequences of damages.  
The customer must check the right choice of the products with the real service conditions.